

Bronze-Liners for Valve Guides

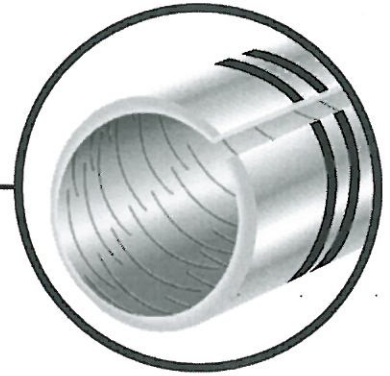

| Size | Part No. | Normal Finished ID | Length | |
|--------|----------|--------------------|-------------|-----------|
| 5mm | S-500 | .196" (5.00mm) x | 2.500" long | Standard |
| 5.5mm | S-550 | .216" (5.49mm) x | 2.500" long | Standard |
| 6 mm | U-599 | .234" (5.94mm) x | 2.500" long | Undersize |
| | S-600 | .236" (6.00mm) x | 2.500" long | Standard |
| | S-610 | .236" (6.00mm) x | 3.000" long | Standard |
| 6.6 mm | S-660 | .260" (6.60mm) x | 2.500" long | Standard |
| 7mm | U-698 | .273" (6.93mm) x | 2.500" long | Undersize |
| | U-699 | .274" (6.96mm) x | 2.500" long | Undersize |
| | U-6993 | .274" (6.96mm) x | 3.000" long | Undersize |
| | S-700 | .276" (7.01mm) x | 2.500" long | Standard |
| | S-710 | .276" (7.01mm) x | 3.000" long | Standard |
| | S-713 | .279" (7.09mm) x | 2.500" long | Standard |
| | S-715 | .281" (7.14mm) x | 2.500" long | Standard |
| 5/16" | U-1112 | .310" (7.87mm) x | 2.000" long | Undersize |
| | U-1122 | .310" (7.87mm) x | 2.500" long | Undersize |
| | U-1132 | .310" (7.87mm) x | 3.000" long | Undersize |
| | S-1210 | .312" (7.92mm) x | 2.000" long | Standard |
| | S-1220 | .312" (7.92mm) x | 2.500" long | Standard |
| | S-1230 | .312" (7.92mm) x | 3.000" long | Standard |
| 8mm | U-1302 | .3125" (7.94mm) x | 2.500" long | Undersize |
| | U-1312 | .313" (7.95mm) x | 2.000" long | Undersize |
| | U-1322 | .313" (7.95mm) x | 2.500" long | Undersize |
| | U-1332 | .313" (7.95mm) x | 3.000" long | Undersize |
| | S-1410 | .315" (8.00mm) x | 2.000" long | Standard |
| | S-1420 | .315" (8.00mm) x | 2.500" long | Standard |
| | S-1430 | .315" (8.00mm) x | 3.000" long | Standard |
| 8.05mm | S-1440 | .317" (8.05mm) x | 2.500" long | Standard |
| | S-1450 | .317" (8.05mm) x | 3.000" long | Standard |
| 11/32" | U-1522 | .341" (8.66mm) x | 2.250" long | Undersize |
| | U-1532 | .341" (8.66mm) x | 2.500" long | Undersize |
| | U-1525 | .338" (8.59mm) x | 2.250" long | Undersize |
| | U-1535 | .338" (8.59mm) x | 2.500" long | Undersize |
| | U-1541 | .338" Special x | 2.500" long | Undersize |
| | S-1620 | .343" (8.71mm) x | 2.250" long | Standard |
| | S-1630 | .343" (8.71mm) x | 2.500" long | Standard |
| | S-1640 | .343" (8.71mm) x | 3.000" long | Standard |
| | S-1641 | .343" Special x | 2.500" long | Standard |
| 9mm | S-1690 | .354" (9.00mm) x | 2.500" long | Standard |
| 3/8" | U-1712 | .371" (9.42mm) x | 2.250" long | Undersize |
| | U-1722 | .371" (9.42mm) x | 2.500" long | Undersize |
| | U-1732 | .371" (9.42mm) x | 3.000" long | Undersize |
| | U-1715 | .368" (9.35mm) x | 2.250" long | Undersize |
| | U-1725 | .368" (9.35mm) x | 2.500" long | Undersize |
| | U-1735 | .368" (9.35mm) x | 3.000" long | Undersize |
| | S-1810 | .373" (9.47mm) x | 2.250" long | Standard |
| | S-1821 | .373" (9.47mm) x | 2.625" long | Standard |
| | S-1830 | .373" (9.47mm) x | 3.000" long | Standard |
| | S-1831 | .375" (9.53mm) x | 3.000" long | Standard |



CLASSIC

 Engine Supplies, Inc.



FONDERA LIMITED

 ENGINE REBUILDING MACHINES

 Unit 3 Tower Industrial Estate, Berinsfield,

 Wallingford, Oxfordshire OX10 7LN England

 Tel: 01865 341 900 Fax: 01865 341 440

www.fondera.co.uk